

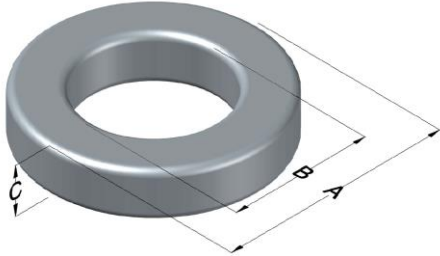

**0055245A2**

110 Delta Drive  
 Pittsburgh, PA 15238  
 NAFTA Sales: (1)800-245-3984  
 HK Sales : (852)3102-9337  
 magnetics@spang.com



MPP Permeability ( $\mu$ )	$A_L$ (nH/T <sup>2</sup> )	Core Marking			Coating Color
		Lot Number	Part Number	Inductance Grade	
75	33 ± 8%	XXXXXX	55245A2	N/A	Grey

Dimensions	Uncoated		Coated Limits			Packaging
	(mm)	(in)	(mm)	(in)		
OD (A)	6.60	0.260	7.24	0.285	max	Cardboard cut-outs Box Qty = TBD
ID (B)	2.67	0.105	2.16	0.085	min	
HT (C)	2.54	0.100	3.18	0.125	max	

Electrical Characteristics			Physical Characteristics						
Watt Loss @ 100 kHz, 100 mT max (mW/cm <sup>3</sup> )	DC Bias min (oersteds)		Voltage Breakdown wire to wire min (V <sub>AC</sub> )	Break Strength min (kg)	Window Area W <sub>a</sub> (mm <sup>2</sup> )	Cross Section A <sub>e</sub> (mm <sup>2</sup> )	Path Length L <sub>e</sub> (mm)	Volume V <sub>e</sub> (mm <sup>3</sup> )	Est. Weight (g)
	80%	50%							
750	35	70	1250	11.3	3.66	4.76	13.6	65	0.57

Winding Information					Temperature Rating		
Winding Length Per Turn				Wound Coil Dimensions (mm)			Curie Temp: 460°C
Winding Factor	(mm)	Winding Factor	(mm)	40% Winding Factor		Notes:	
				OD	HT		
0%	11.4	40%	ERROR	Completely Full Window	Max OD	11.7	
20%	ERROR	45%	ERROR		Max HT	3.18	
25%	ERROR	50%	ERROR	Surface Area (mm <sup>2</sup> )			
30%	ERROR	60%	ERROR	Unwound Core		170	
35%	ERROR	70%	ERROR	40% Winding Factor		350	

**Typical DC Bias Performance**

