

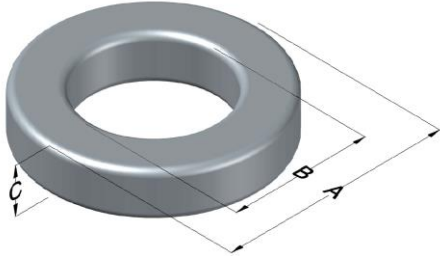

0055244A2

110 Delta Drive
 Pittsburgh, PA 15238
 NAFTA Sales: (1)800-245-3984
 HK Sales : (852)3102-9337
 magnetics@spang.com



MPP Permeability (μ)	A_L (nH/T ²)	Core Marking			Coating Color
		Lot Number	Part Number	Inductance Grade	
90	39 ± 8%	XXXXXX	55244A2	N/A	Grey

Dimensions	Uncoated		Coated Limits			Packaging
	(mm)	(in)	(mm)	(in)		
OD (A)	6.60	0.260	7.24	0.285	max	Cardboard cut-outs Box Qty = TBD
ID (B)	2.67	0.105	2.16	0.085	min	
HT (C)	2.54	0.100	3.18	0.125	max	

Electrical Characteristics			Physical Characteristics						
Watt Loss @ 100 kHz, 100 mT max (mW/cm ³)	DC Bias min (oersteds)		Voltage Breakdown wire to wire min (V _{AC})	Break Strength min (kg)	Window Area W _a (mm ²)	Cross Section A _e (mm ²)	Path Length L _e (mm)	Volume V _e (mm ³)	Est. Weight (g)
	800	80%							
	30	55							

Winding Information					Temperature Rating	
Winding Length Per Turn				Wound Coil Dimensions (mm)		Curie Temp: 460°C
Winding Factor	(mm)	Winding Factor	(mm)	40% Winding Factor		Notes:
				OD	HT	
0%	11.4	40%	ERROR	Max OD	11.7	
20%	ERROR	45%	ERROR	Max HT	3.18	
25%	ERROR	50%	ERROR	Completely Full Window		
30%	ERROR	60%	ERROR	Surface Area (mm ²)		
35%	ERROR	70%	ERROR	Unwound Core	170	
				40% Winding Factor	350	

