

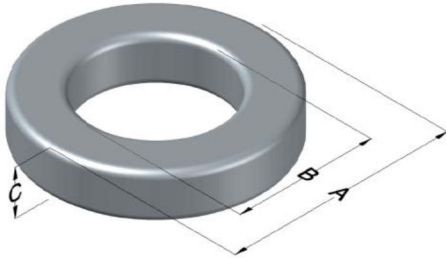

0055164A2

110 Delta Drive
 Pittsburgh, PA 15238
 NAFTA Sales: (1)800-245-3984
 HK Sales : (852)3102-9337
 magnetics@spang.com
 www.mag-inc.com



MPP Permeability (μ)	A_L (nH/T ²)	Core Marking			Coating Color
		Lot Number	Part Number	Inductance Grade	
14	42 ± 8%	XXXXXX	55164A2	N/A	Grey

Dimensions	Uncoated		Coated Limits			Packaging
	(mm)	(in)	(mm)	(in)		
OD (A)	165.10	6.500	166.50	6.555	max	Cardboard cut-outs Box Qty= 6 pcs
ID (B)	102.41	4.032	101.02	3.977	min	
HT (C)	31.75	1.250	33.15	1.305	max	

Electrical Characteristics			Physical Characteristics						
Watt Loss @ 100 kHz, 50mT Max (mW/cm ³)	DC Bias min (oersteds)		Voltage Breakdown wire to wire min (V _{AC})	Break Strength min (kg)	Window Area W _A (mm ²)	Cross Section A _e (mm ²)	Path Length L _e (mm)	Volume V _e (mm ³)	Weight (g)
	80%	70%							
650	200	260	3000	227.0	8,030	987	412	407,000	2960

Winding Information					Temperature Rating	
Winding Length Per Turn				Wound Coil Dimensions (mm)		Curie Temp: 460°C
Winding Factor	(mm)	Winding Factor	(mm)	40% Winding Factor		Coating Temp (Continuous up to): 200°C
				OD	182	
				HT	63.2	Notes:
				Max OD	228	
				Max HT	103	
0%	132	40%	184	Completely Full Window		
20%	158	45%	192	Surface Area (mm ²)		
25%	164	50%	199			
30%	170	60%	215	Unwound Core	55,000	
35%	178	70%	233	40% Winding Factor	102,000	

Typical DC Bias Performance

